

500 West Main St.

Babylon, NY

Sublease



Building Size:

Approx. 40,000 sf

Available Suite:

5,088 sf on the 2nd floor (can divide)

Sublease Term:

Until 6/30/14 (longer term possible)

Available Suite Consists of:

- Reception
- Waiting room
- 8 offices with windows
- Conference room
- Break room with sink
- 35 workstations
- Storage room
- Storage closet

Office / Medical Building:

- Great Parking
- Furniture can be made available
- Currently built out as office space but can be converted for medical use
- Close proximity to Good Samaritan Hospital

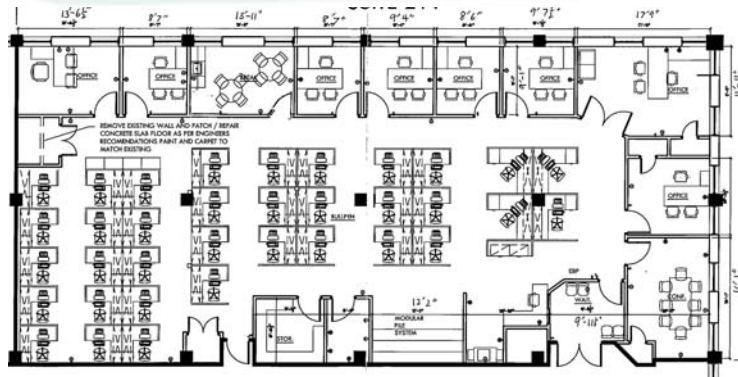

For Additional Information Contact Exclusive Brokers:

Joe Lopresti

516-433-9000 ext. 1515

JoeLopresti@Concorde-Li.com

Dan Flynn

516-433-9000 ext. 1516

DanFlynn@Concorde-Li.com

Concorde Real Estate Company, Inc. • 9 Gerhard Rd. Plainview, NY 11803 • Tel: 516-433-9000 • www.Concorde-Li.com



The information contained herein was obtained from sources we believe to be reliable. But please take notice that we are not responsible for, do not attest to, or invite your reliance upon the accuracy of this information. All information is submitted subject to errors, omissions, changes, withdrawal without notice, and any special listing conditions of Owner.